

*Courses And Distances
Down the River*

S 14° W	44
S 18 W	48
S 33½ W	48
S 30 W	34
S 45 W	30
S 50 W	25
<hr/>	
	229 perches

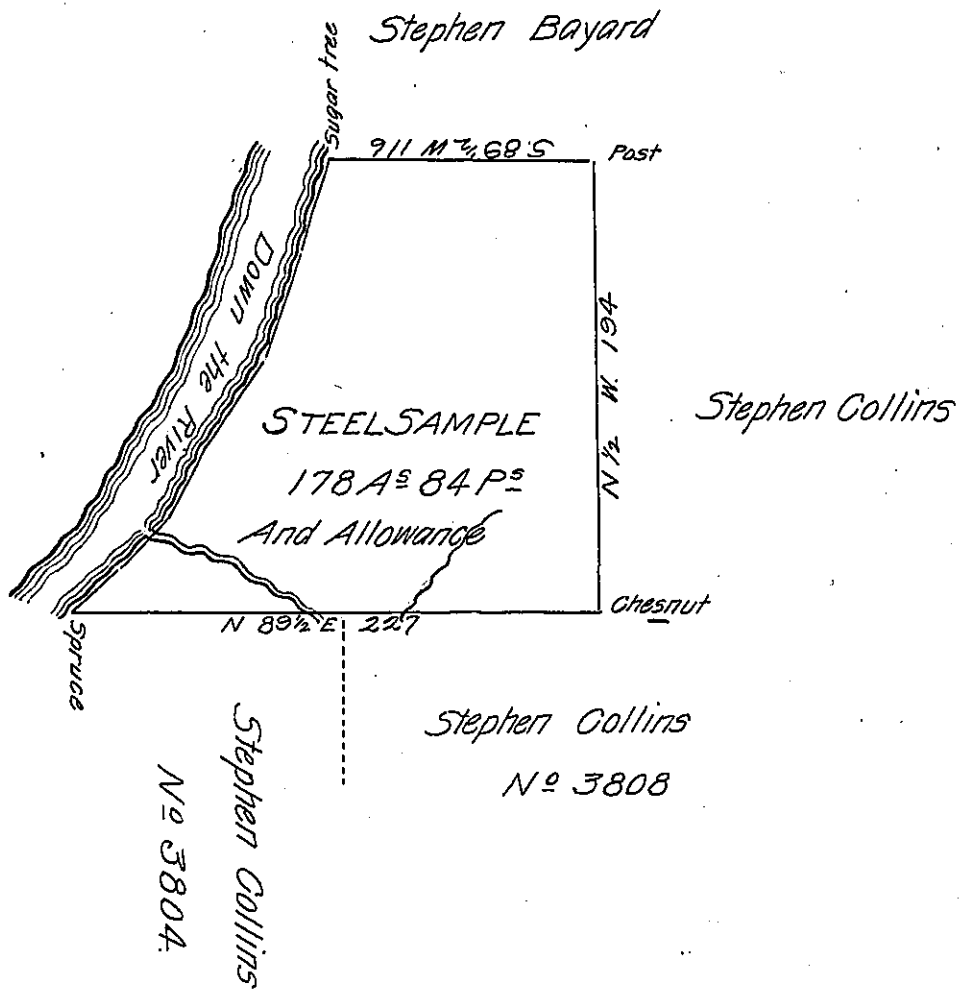

*In pursuance of An Order dated April 28th A.D. 1828 Resurveyed the above de-
scribed tract of land Containing by the same, one hundred and seventy eight Acres,
eighty four perches and the Allowance of six P. Ct. &c. Situate in Kittanning town-
ship Armstrong County Adjoining the Allegany River, Lands Surveyed to Stephen
Bayard And Stephen Collins.*

*Gabriel Heister Esq. }
Surveyor General }*

Robert Richards D.S.

*N.B. The Above Resurvey was Made May 7th 1828. And the Number of the
Warrant by which the land Was first Surveyed is 748.*

R. R.

IN TESTIMONY that the above is a copy of the original remaining on file in
the Department of Internal Affairs of Pennsylvania, made
comformably to an Act of Assembly approved the 16th day of
February 1833, I have hereunto set my hand and caused
the Seal of said Department to be affixed at Harrisburg,
this eleventh day of January 1907.

Leach R. Brown
Secretary of Internal Affairs.